

CONSTRUCT PLATFORM 4" ABOVE PRESENT PLATFORM
 FINISH SAME AS PRESENT PLATFORM

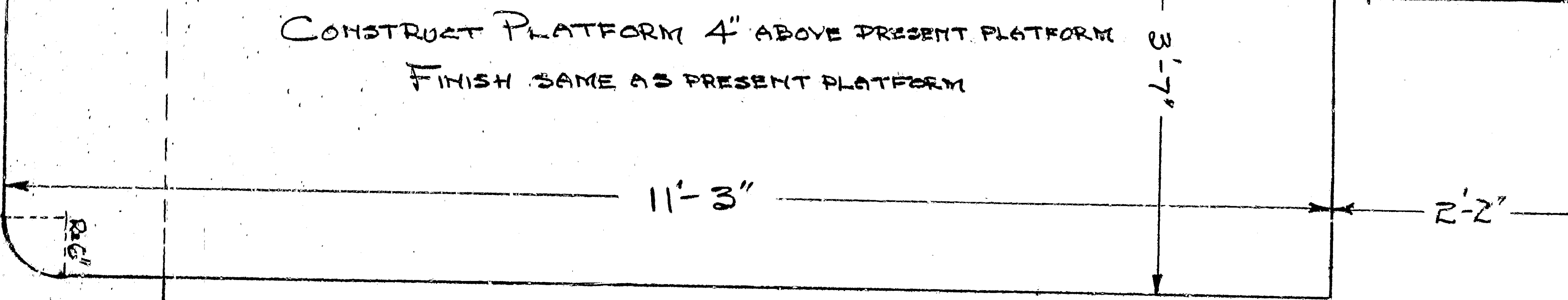

2'-11"

EXTEND PRESENT PLATFORM 3 FEET

Move Railing to New Location

21'-3"

DATUM
 To the elevation above
 this 'Standard Datum of
 1989'

POLICE COURT

Face of Wall

W. Shultz
 Architect

Door

1'-2" 0'-3"

2'-11"

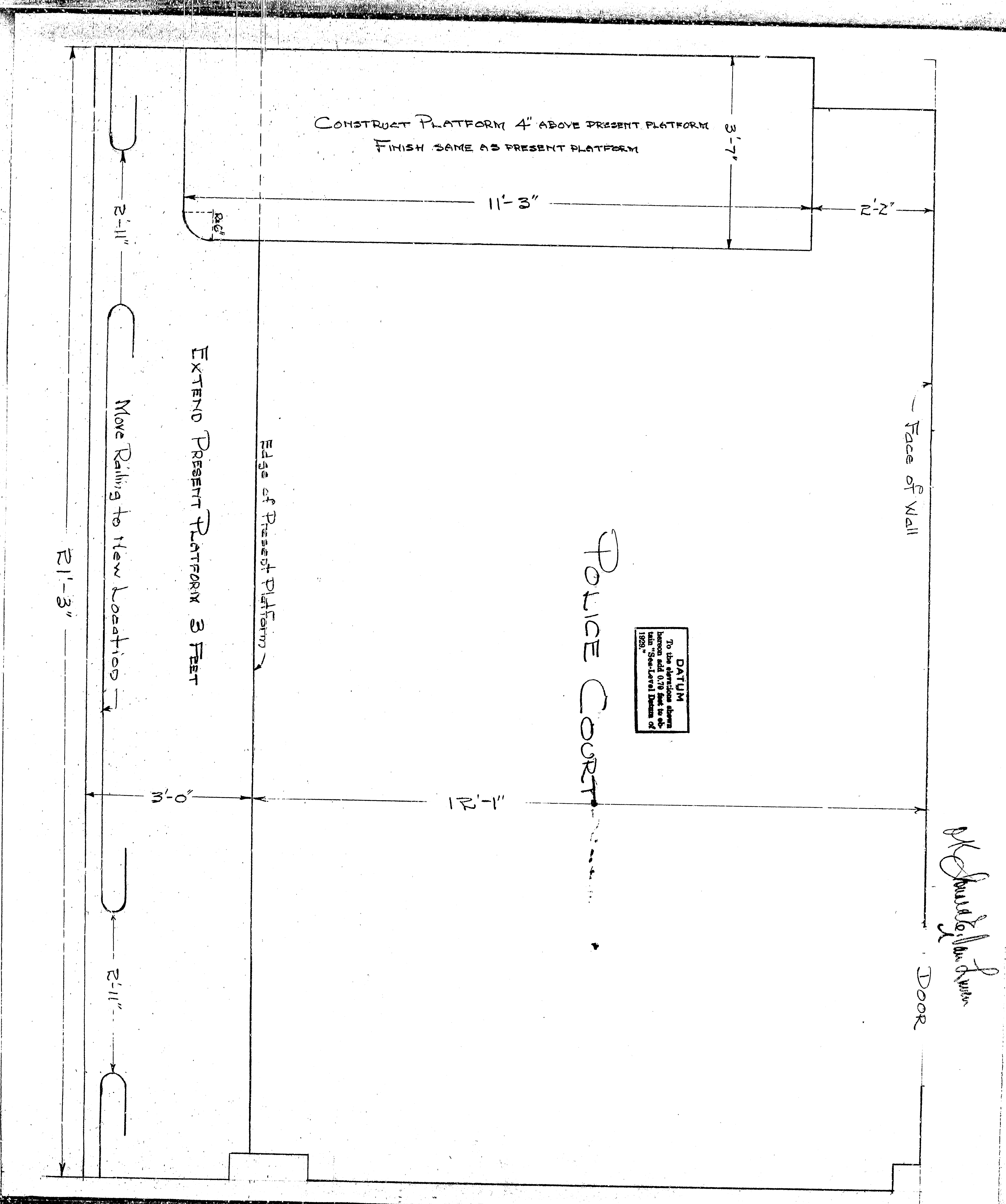

CONSTRUCT PLATFORM 4" ABOVE PRESENT PLATFORM
 FINISH SAME AS PRESENT PLATFORM

DATUM
 To the elevation above
 the "Standard Datum of
 1929"

W. S. ...
 Door

POLICE COURT

EXTEND PRESENT PLATFORM 3 FEET

Move Railing to New Location

21'-3"

2'-11"

11'-3"

3'-7"

2'-2"

3'-6"

0'-3"

1'-2"

2'-11"

2'-11"

Face of Wall

Edge of Present Platform